

RS

GLK-2000

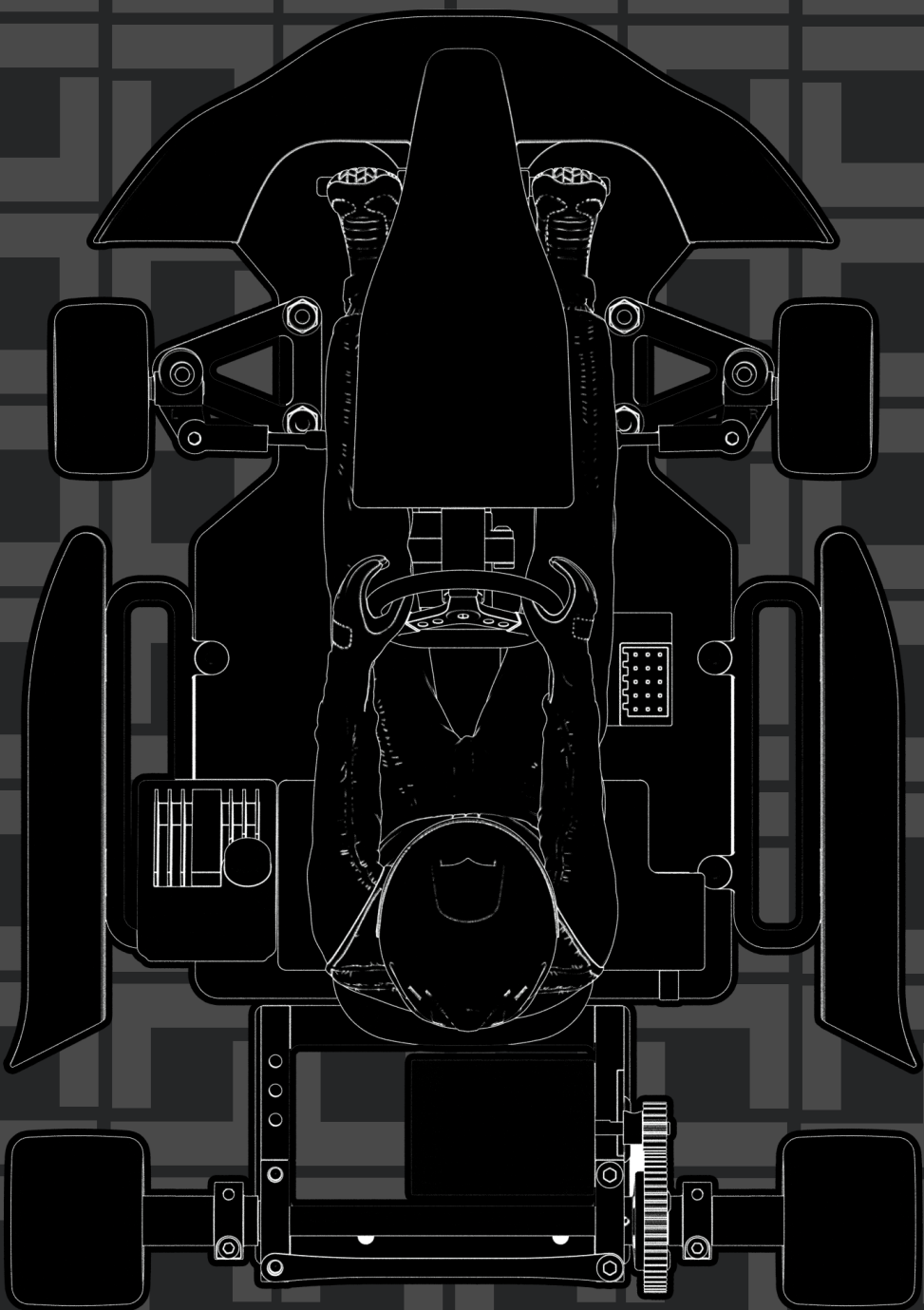

Thank you for purchasing this TEAMSAXO product. This high performance competition kit has been proudly manufactured by TEAMSAXO World Champion R/C car manufacturer.
Proper assembly of this product will provide fun,safe enjoyment.

PRECAUTIONS FOR SAFE ENJOYMENT OF YOUR R/C CAR

For children under the age of 13, parental guidance is recommended when running.

ASSEMBLY PRECAUTIONS

Do not assemble around small children. The parts can be dangerous if accidentally swallowed.

Check the contents carefully before assembly. Please contact Customer Support if you happen to notice any defective or missing items.

You will find the assembly process much easier by carefully reading through the manual,and familiarizing yourself with the instructions.

Many different tools are required during assembly. For safety purposes,please use suitable tools. Exercise extra caution when using a sharp tool such as a hobby knife.

Many different materials are used for the parts. Use extra care when handling parts with sharp edges, such as machined metal parts.

When cutting plastic parts,watch for any flying parts.

Try to assemble any rotating parts of drivetrain parts as smooth as possible.

Bundle wires neatly away from the ground or any moving drivetrain components.Make sure that all wires are properly connected to prevent shorting.

Unnecessary modifications may be unsafe and hinder performance.

Always paint in a well ventilated area away from flames.

PRECAUTIONS BEFORE RUNNING

Teamsaxo R/C cars are built for competition use,and some models may exceed speeds of 40km per hour. Practice common sense and run the car in open safe places,or R/C car tracks.

Do not run the car on public roads with high amounts of traffic,or in areas that may cause an inconvenience to people in that area.

R/C cars are controlled using radio frequency.In a worst-case scenario.radio interferences may cause loss of control.

If others near you are running R/C cars,confirm that they are not running on the same frequency.

R/C cars do not like water.Avoid running on rainy days,or areas with water puddles.Exposure of the electronics to water may cause loss of control or damage to the electronics

The drivetrain of an R/C car consists of many moving parts like gears,belts,shafts,and tires.Avoid touching these areas when the battery is connected.

Many parts of an R/C car will become hot after running. Allow the parts to sufficiently cool before conducting any maintenance

BEGINNING A RUN

- 1.Place the R/C car on a stand so the wheels are off the ground.
- 2.Confirm that the speed controller switch is OFF,and connect the motor and battery
- 3.Extend the transmitter antenna and turn the switch ON. (It is unsafe to use a transmitter with low voltage.Make sure that the transmitter batteries are good before running)
- 4.Turn the speed controller switch ON.

FINISHING A RUN

- 1.Turn the speed controller switch OFF.
- 2.Disconnect the battery.
- 3.Turn the transmitter switch OFF,and retract the antenna.

ASSEMBLING TOOLS REQUIRED (NOT INCLUDED IN KIT)

Scissors

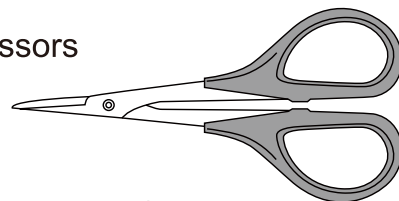

Modeling knife



Side cutters

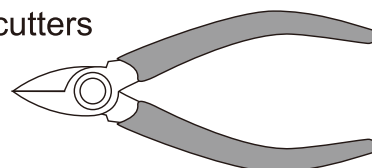

Long nose pliers

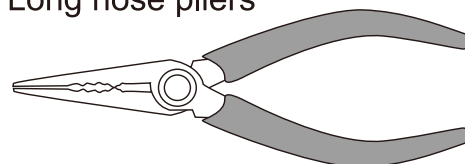

Hex wrench (1.5mm)

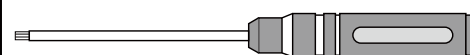

Hex wrench (2mm)

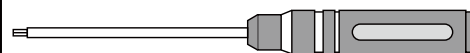

Tweezers



GK-200 CHASSIS SPECIFICATION

Overall Length	: 256mm	Overall Width	Front width :186.45mm
Wheelbase length	: 171mm		Rear width :185mm
Weight Chassis only	: 620g		

Cap



M3x6 SJG306-B



M3x8 SJG308-B



M3x10 SJG310-B



M3x12 SJG312-B

Cap screw



M2.5x6 SG2.506-B

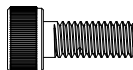

M3x12 SG308-B

E-Ring



E-ring2.0 OE-E2.0-1

Screw



M2x4 SIG204-SI-SZ



M2.5x4 SIG2.504-B



M3x6 SIG306-B



M3x8 SIG308-B



M3x10 SIG310-B



M3x3 TS0304008

Grub screw



Lock nut



M3 SN-M3-F



M3 SN-M3-F-2



M4 SN-M4-F

Ball bearing

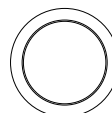

8.4x6.4x0.4 TS0501017



4.7x3.3x0.4 TS0202005



1 ~ 4 Kit Bag A

	OE-E2.0-1.....	2
	TS0201038.....	2
	TS0101030.....	2
	TS0102003.....	2
	TS0101007.....	2
	SIG304-B.....	2
	SIG308-B.....	2
	TS00502008.....	2
	TS00504002/003.....	2
	TS0202001.....	2

	TS0102014.....	2
	TS0104027.....	4
	TS0101007.....	2

	SN-M3-F.....	2
	TS0303012.....	2
	TS0102032.....	2

1 Attaching front uprights

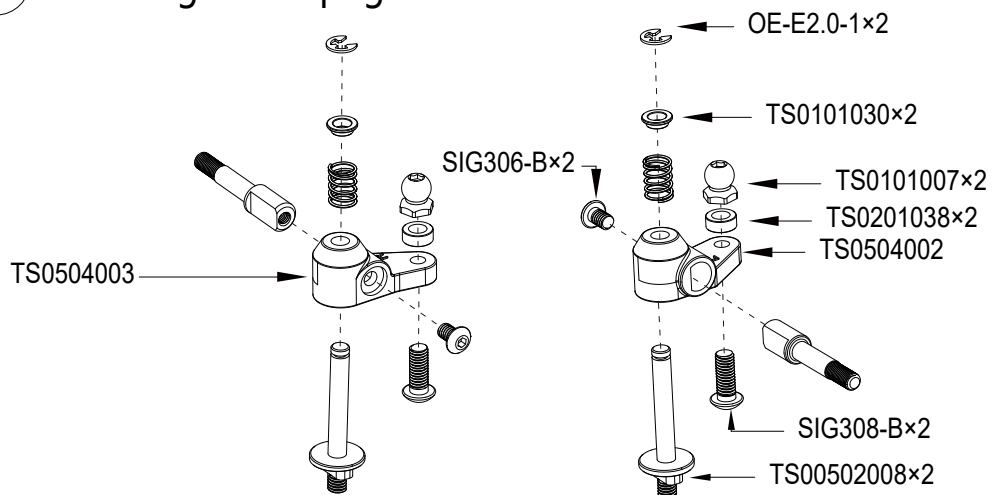

2 Servo saver

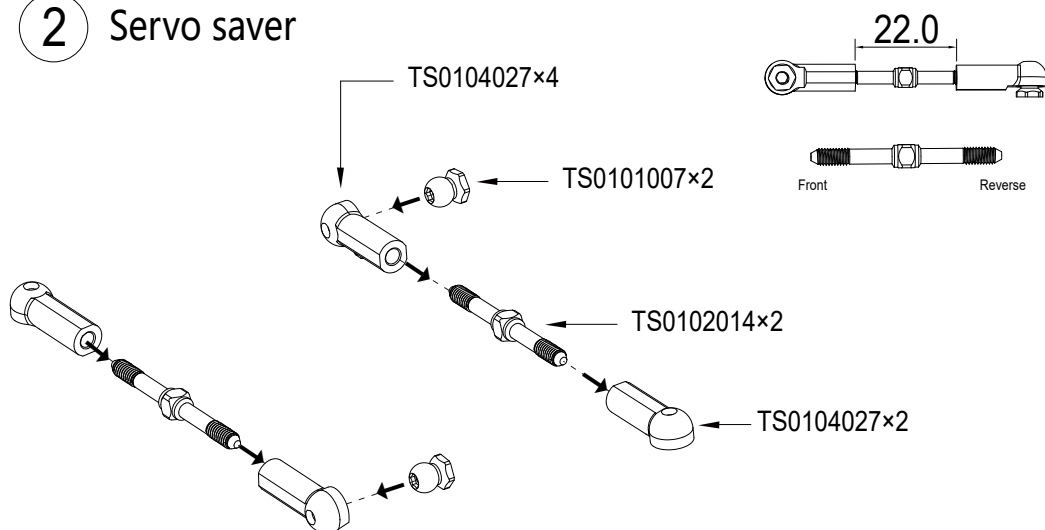

3

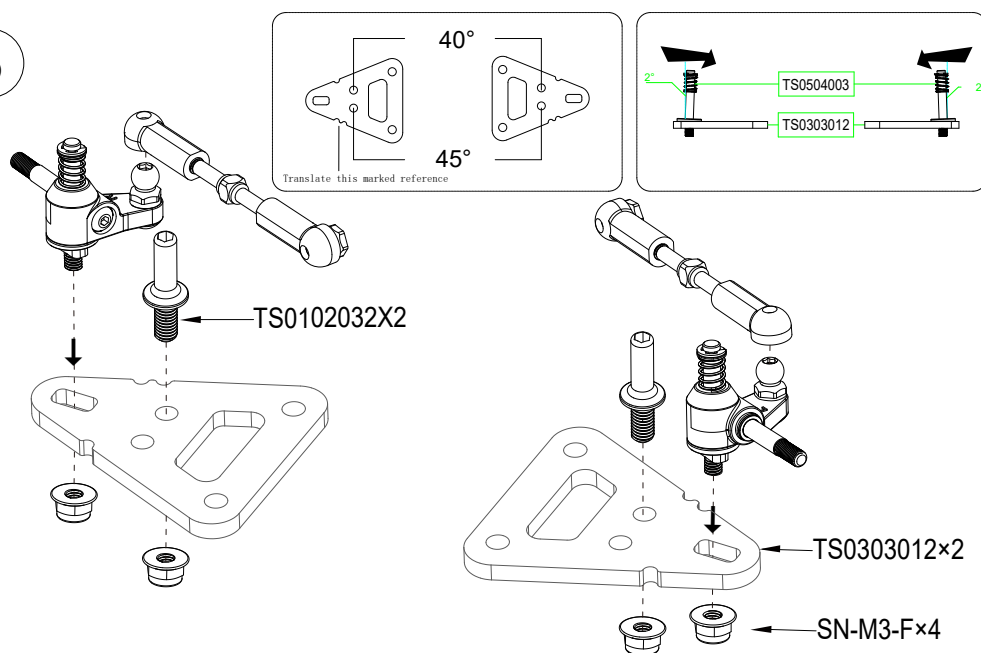

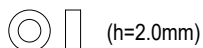

(h=2.0mm)

TS02010384

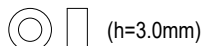

(h=3.0mm)

TS02010394



(M3)

SN-M3-F4

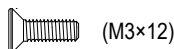

(M3x12)

SJG312-B4

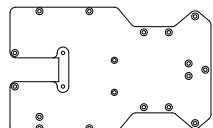

TS03030091

4

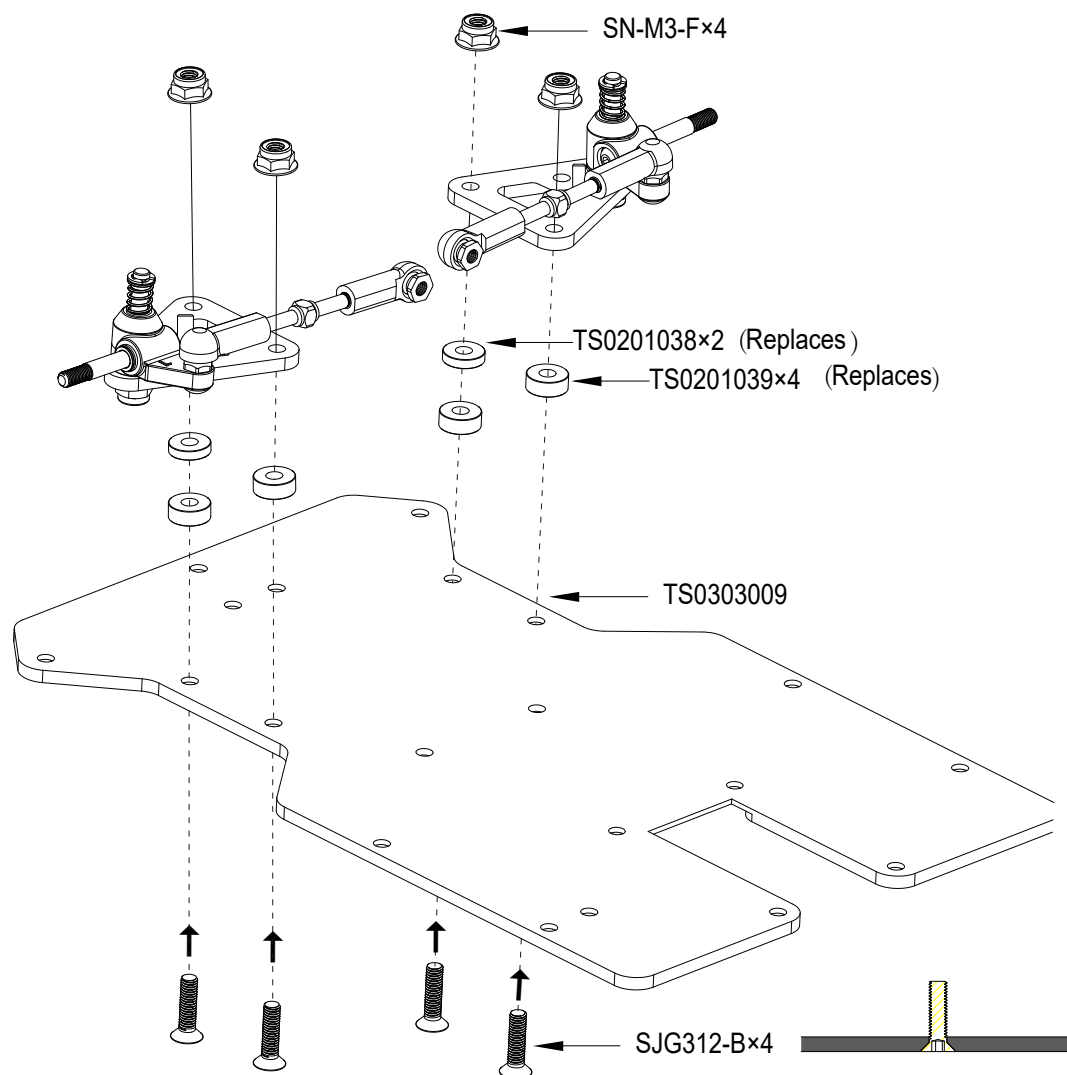

5 ~ 7
Kit Bag B



(M2x4)

SIG204-SI-SZ1

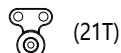

(21T)

RS-928-21T1

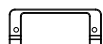

TS03040071

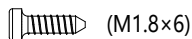

(M1.8x6)

SIG1.806-SI-C2



PC-28061



(0.5mm)

TS03020032

5

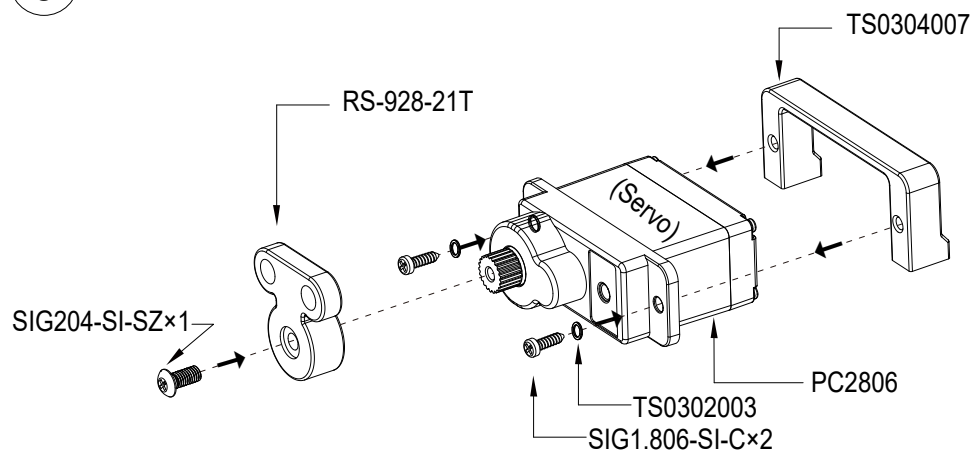

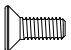
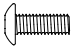

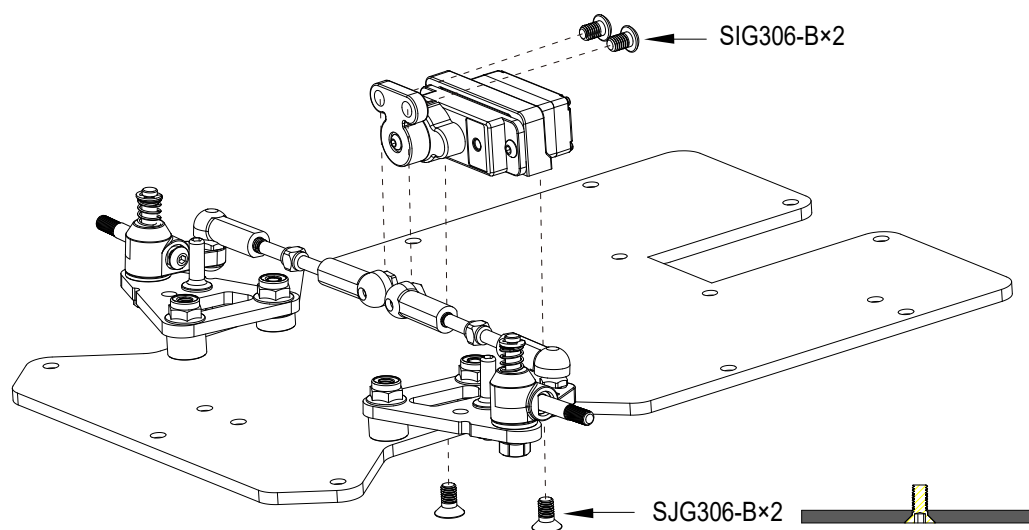

	(M3×6)
SJG306-B	2
	(M3×6)
SIG306-B	2

6 Attaching steering servo

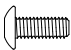
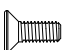

7 ~ 8 Kit Bag C

	(M3×10)
SIG310-B	1
	(M3×6)
SJG306-B	2
	
TS0102001	1
	
TS0304015	1
	
TS0304004	1
	
TS0304005	1

7

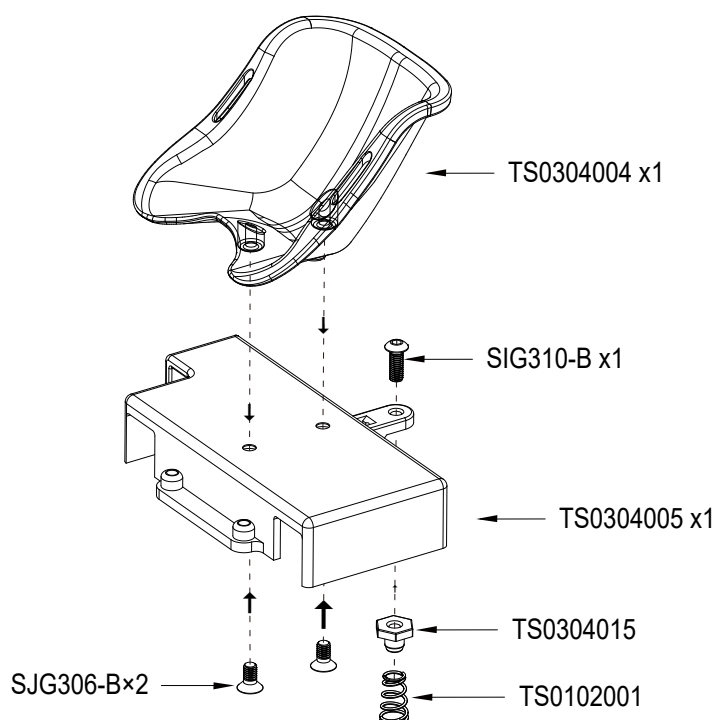



M3×8

SJG308-B.....5

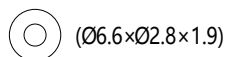

TS0105004.....1



TS0304014.....1

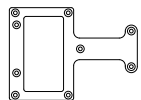

TS0303010.....1

8 Battery assemble position

★ According to the back groove of chassis bind the battery with tape

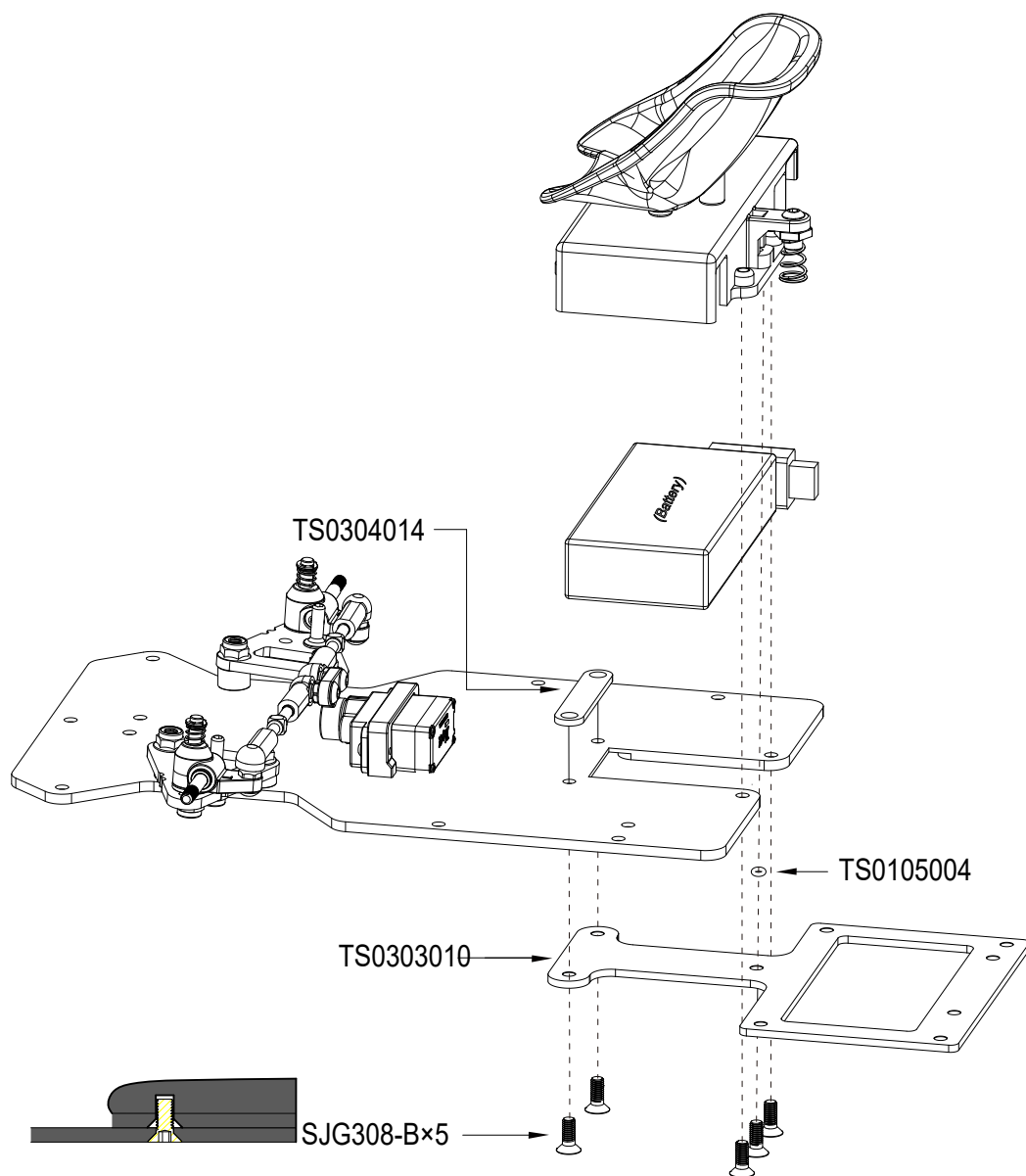



9 ~ 11 Kit Bag D

(M3×6)
SJG306-B.....4

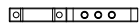

TS0301001.....1

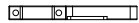

TS0301002.....1

9 Motor mount

★ Assemble on a flat surface to prevent distortion

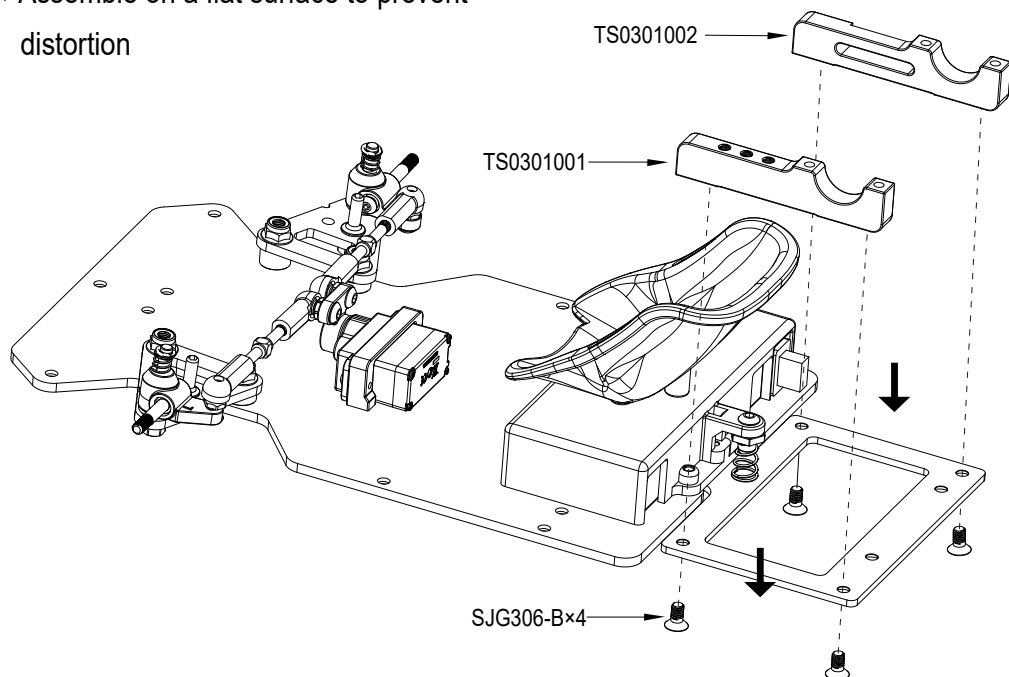

(M3×8)
SIG308-B.....2







SK303-B1

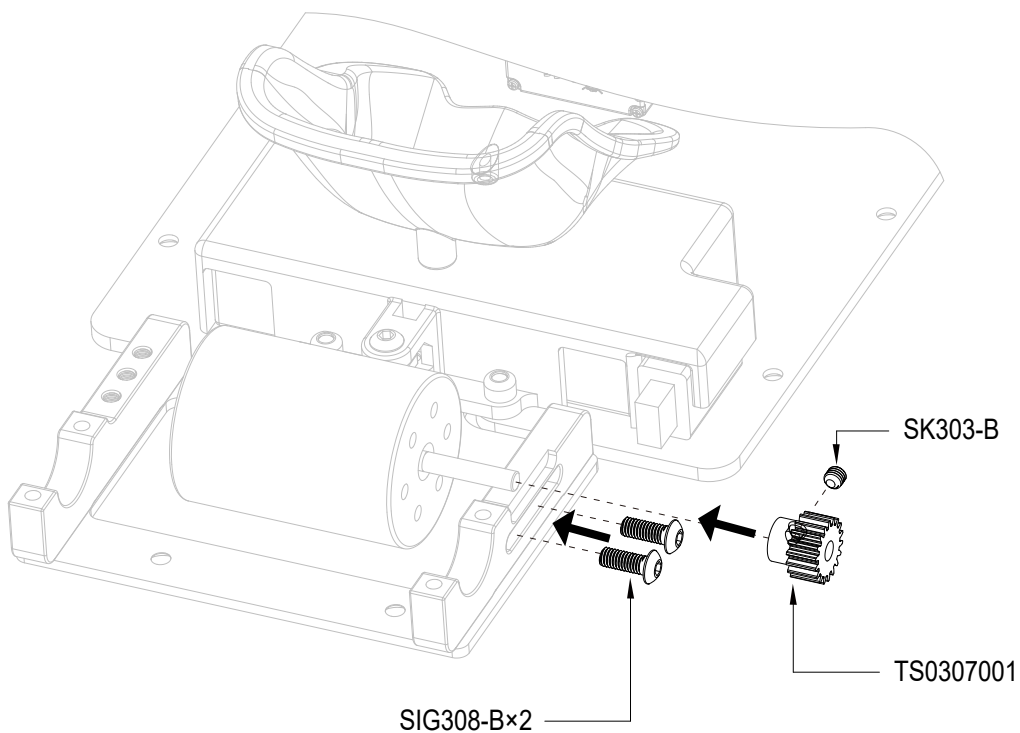

TS0307001.....1

10

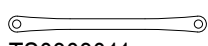

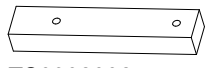
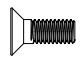

 (M3×8)	
SG308-B.....	4
	
TS0303011.....	1
	
TS0301003.....	2
 (Ø3×Ø5×0.5)	
TS0501020.....	4
	
TS0302002.....	1
 (M3×8)	
SJG308-B.....	2

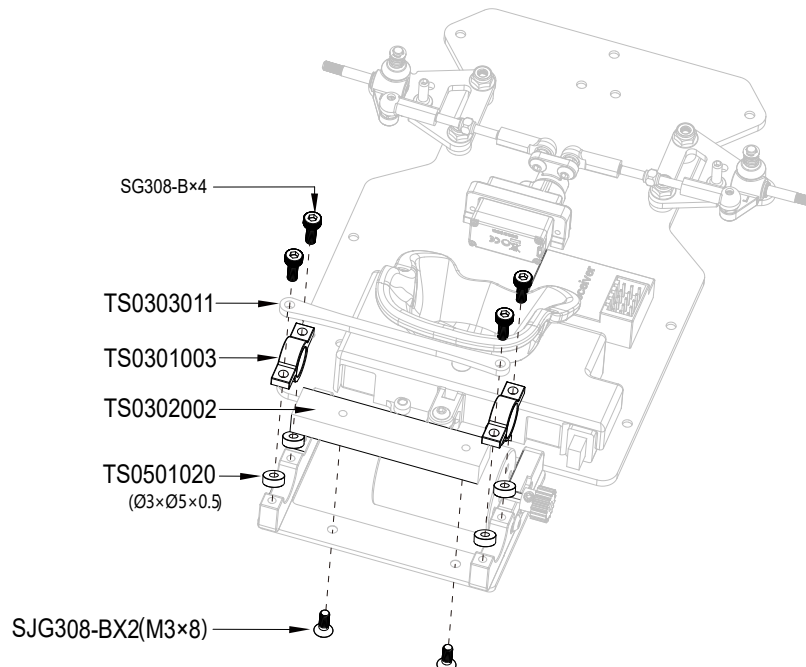
11



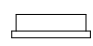

12 ~ 16
Kit Bag E

	
TS05089-1.....	1
 (Ø9.525×Ø6.35×H3.175)	
FR168ZZ-1.....	1
 (Ø8.4×Ø6.4×1.0)	
TS0501017.....	1

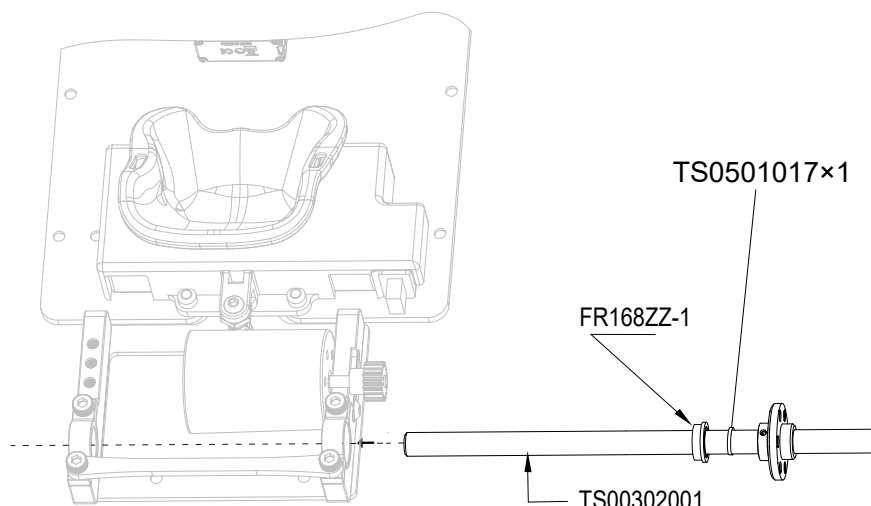
12 Attaching rear shaft

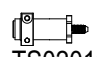
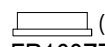
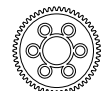
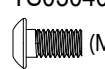

 (M2.5×Ø6)	
SG2.506-B.....	4
	
TS0201045.....	2
 (Ø9.525×Ø6.35×H3.175)	
FR168ZZ-1.....	1
 (48P-54TØ9.525)	
TS0304009.....	1
 (M3×6)	
SIG306-B.....	3
 (Ø8.4×Ø6.4×1.0)	
TS0501017.....	1

13 Attaching rear shaft

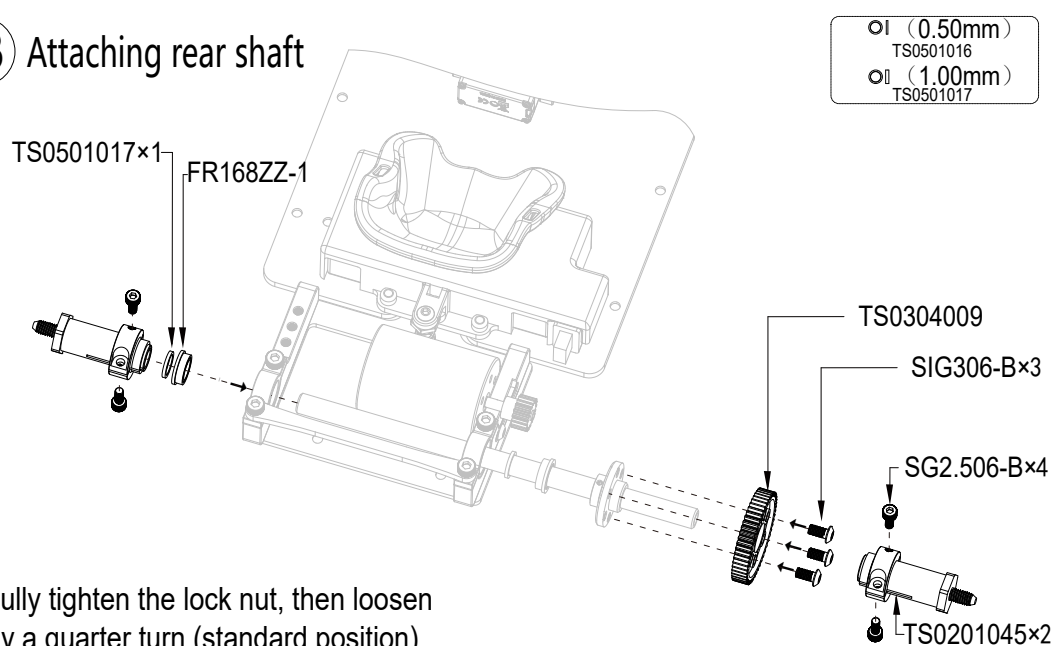

○I (0.50mm)
TS0501016
○II (1.00mm)
TS0501017

★ Fully tighten the lock nut, then loosen
by a quarter turn (standard position)

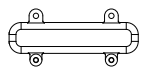

TS0304006 2



SJG308-B 3



SJG312-B 1

14

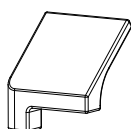
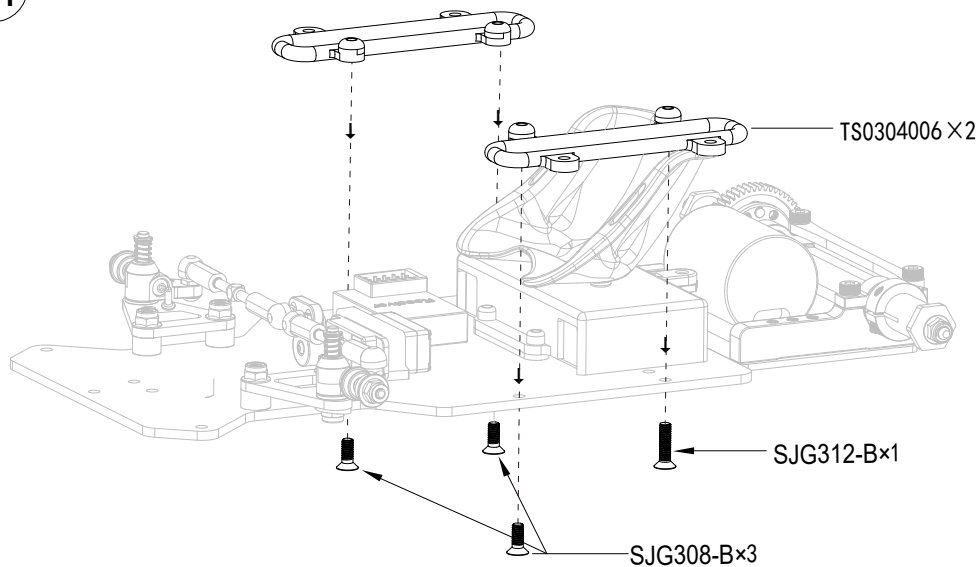

TS0304011 1

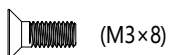

SJG308-B 1

15

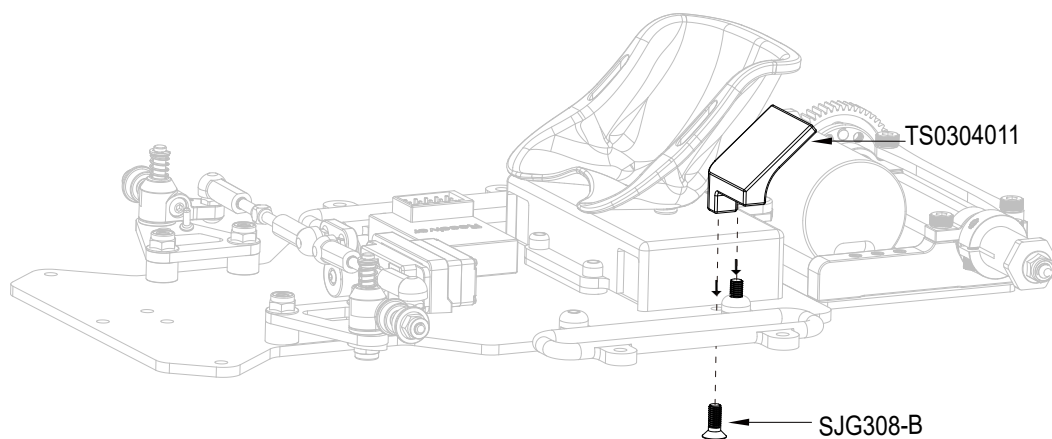

16

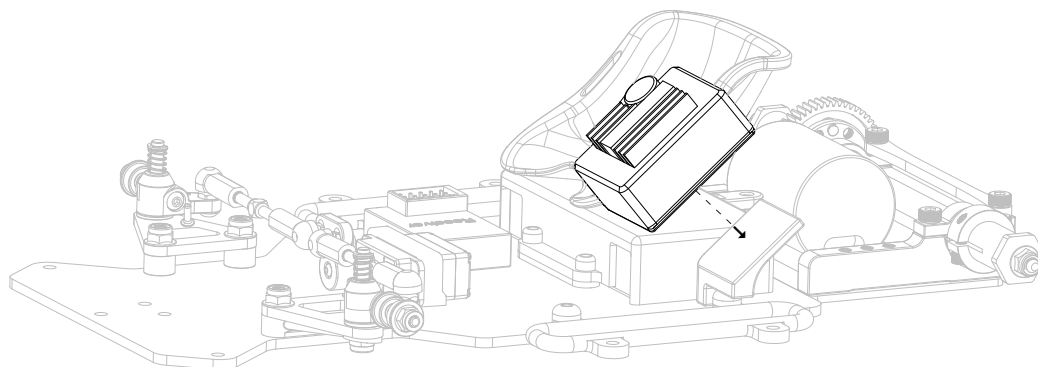



17 ~ 18
Kit Bag F

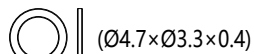

TS0202005.....2

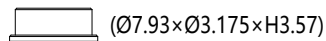

FR2.5ZZ-1.....4



SN-M3-F.....2

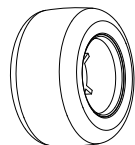

TS03029-1.....2

17 Attaching wheels

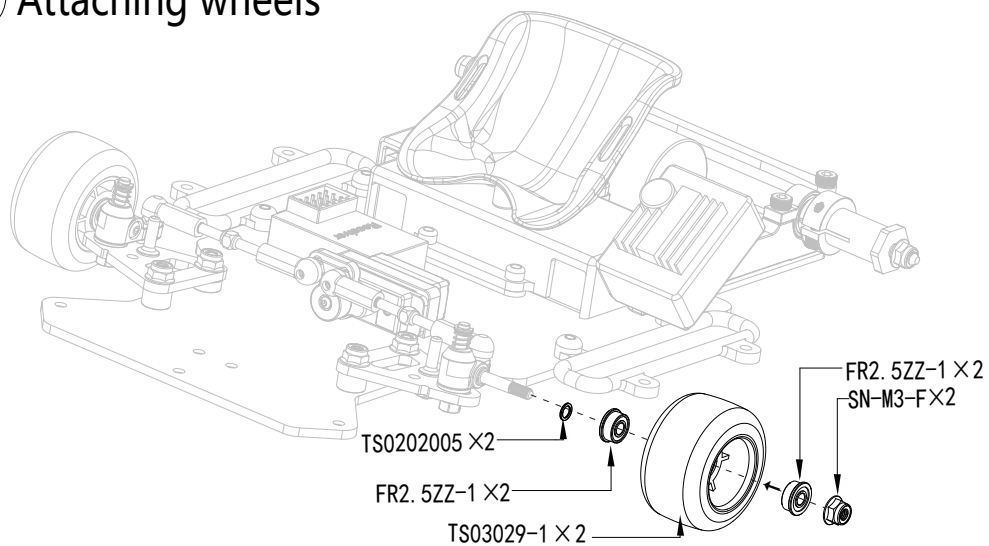

SN-M4-F.....2

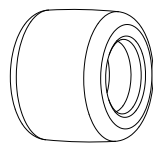

TS03030-1.....2

18

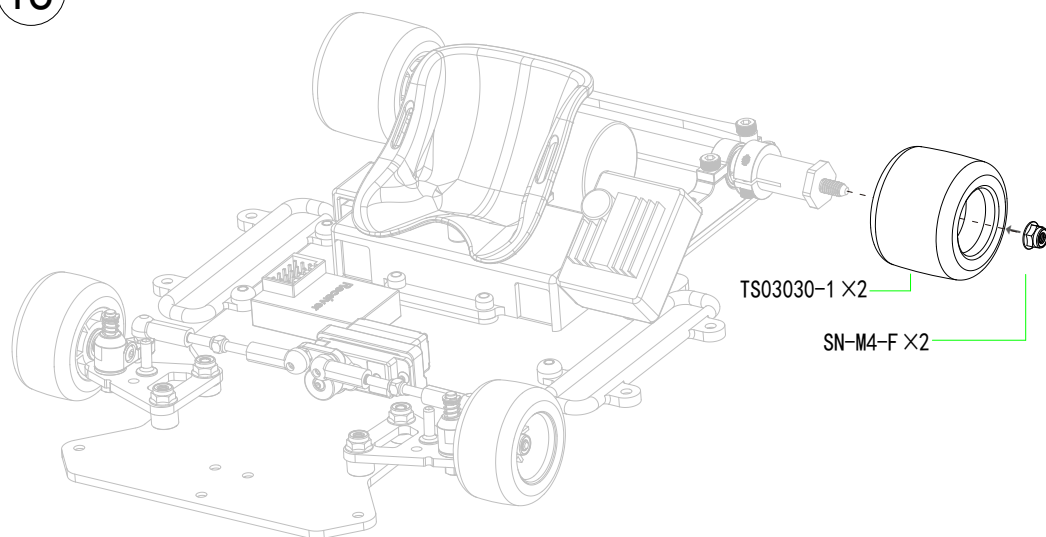

19 ~ 22
Kit Bag G

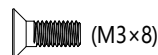

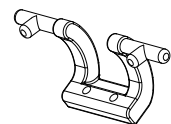

SJG308-B.....2

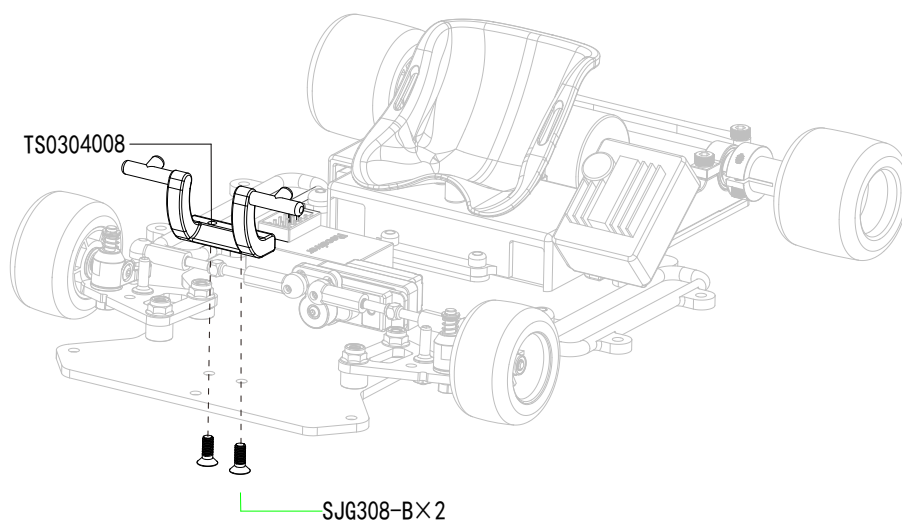

TS0304008.....1

19

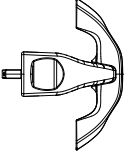

 (M3×10)	
SJG310-B.....	1
	
TS0304010.....	1
	
TS0304001.....	1

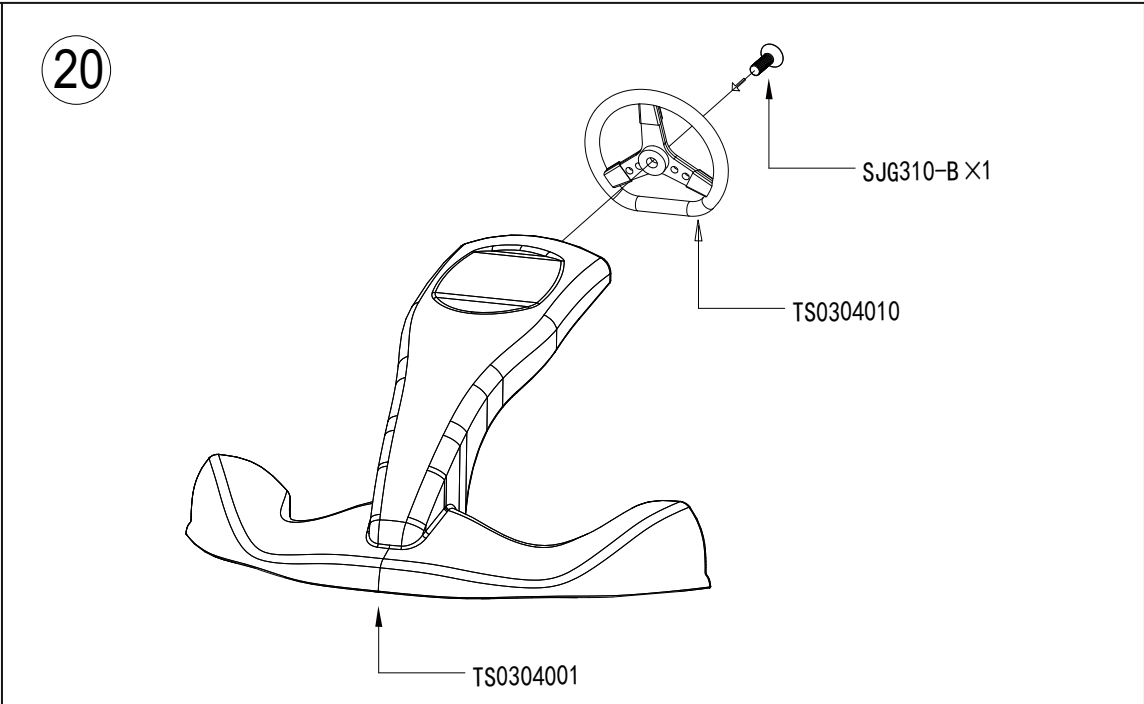

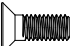
 (M3×8)	
SJG308-B.....	3

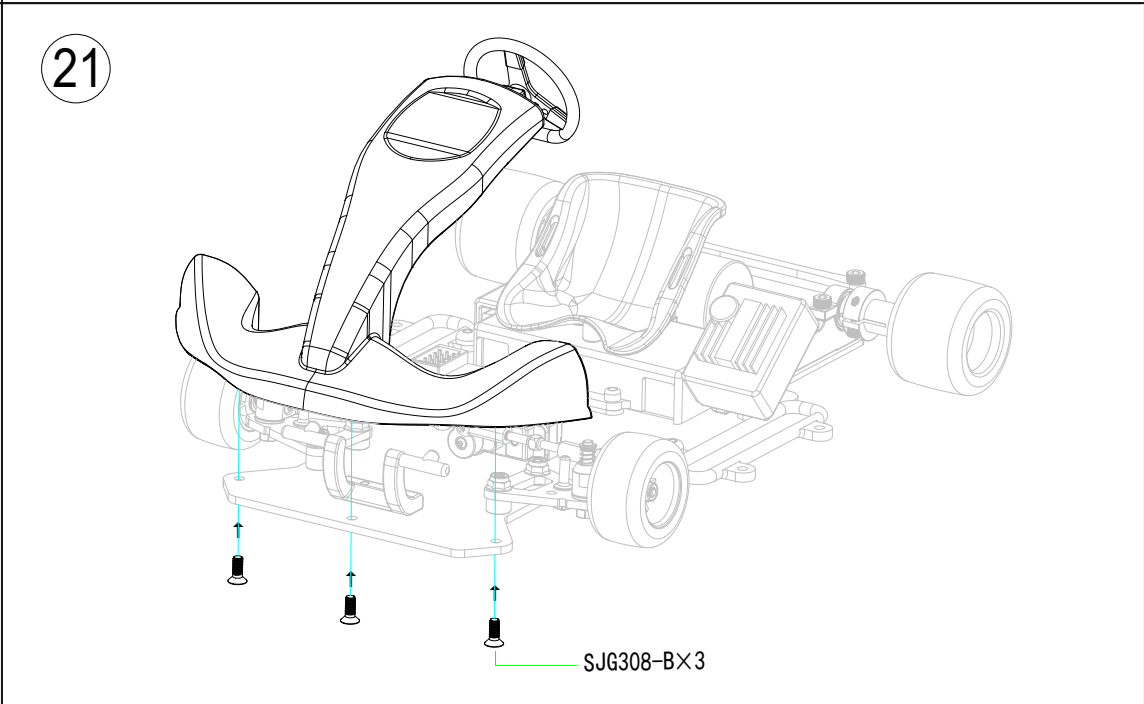

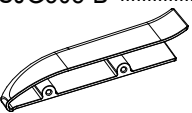
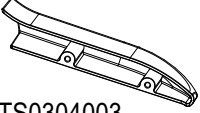
 (M3×8)	
SJG308-B.....	4
	
TS0304002.....	1
	
TS0304003.....	1

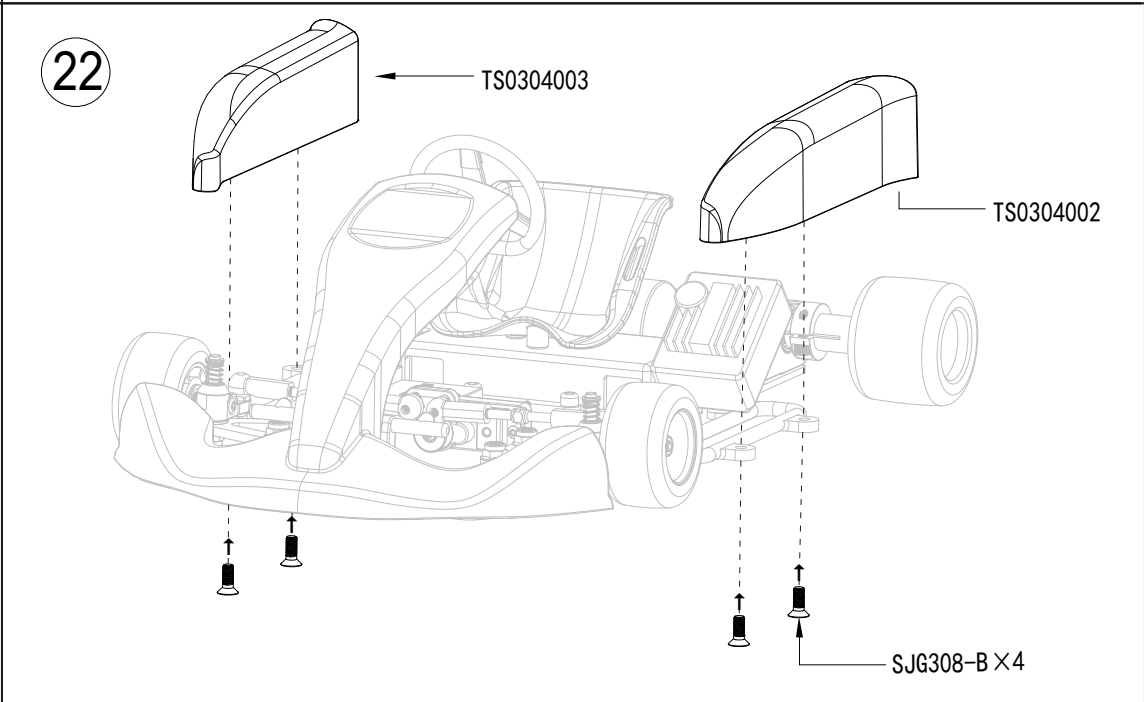



23
Kit Bag H



TS0304016.....1

23

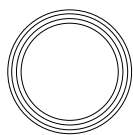
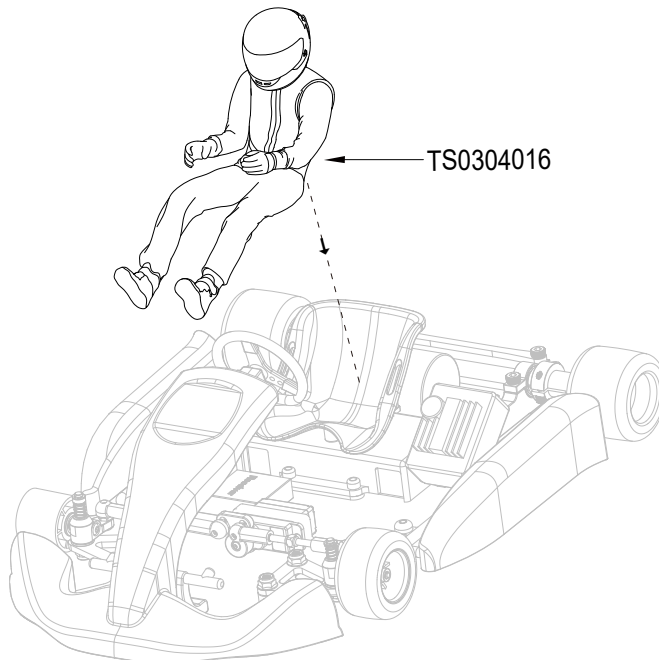

(8×200)

TS0310001.....1

24

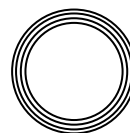
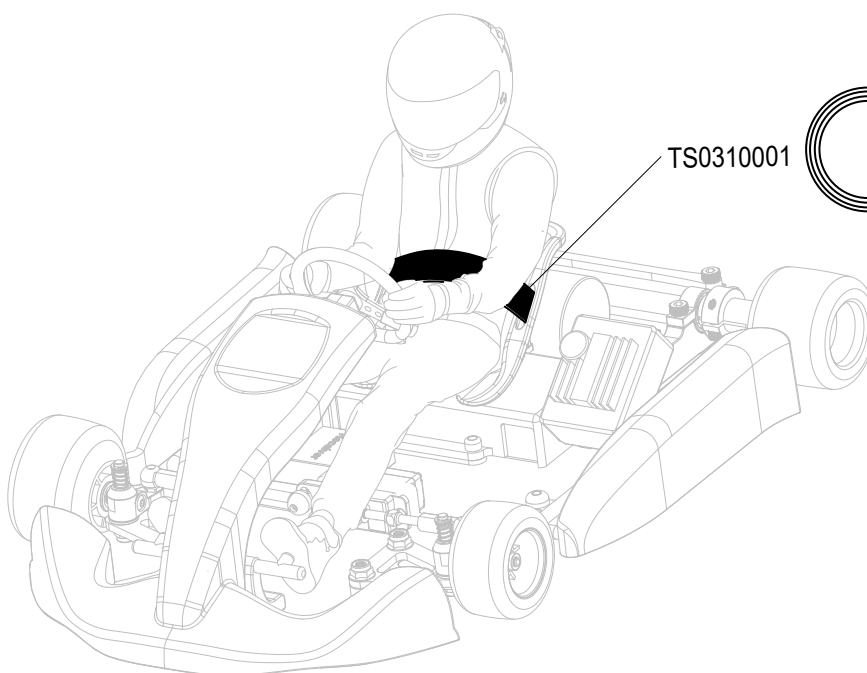

25
Kit Bag I

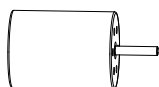

TS0309001.....1

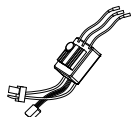

TS0309002.....1

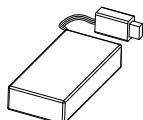

TS0309003-2S1P.....1

25

Pro Version

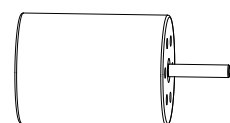
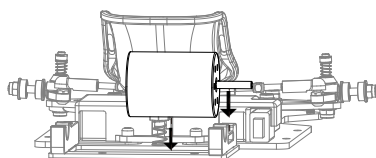

TS0309001 ×1

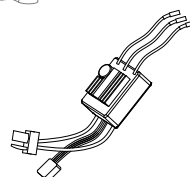
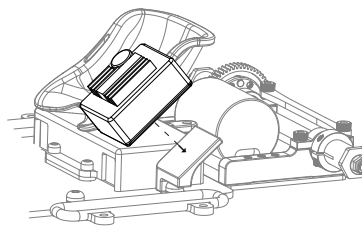

TS0309002×1

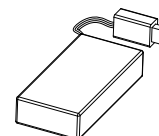
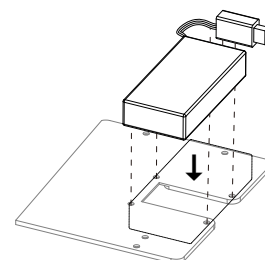

TS0309003-2S1P ×1

SETTING-UP

★ Record various running conditions and settings on the setting sheet on page 11

TOE-IN AND TOE-OUT

★ Translation: Front suspension triangle plate file point angle and example

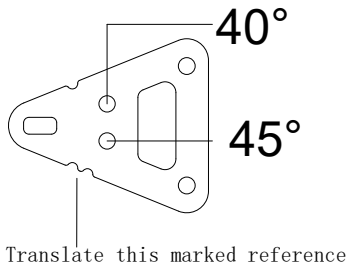

★ Adjust rod length by rotating adjuster

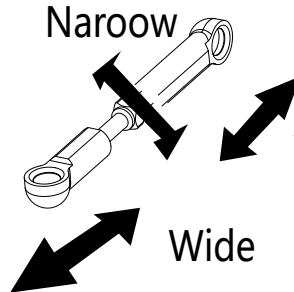

★ Make sure the servo is in neutral

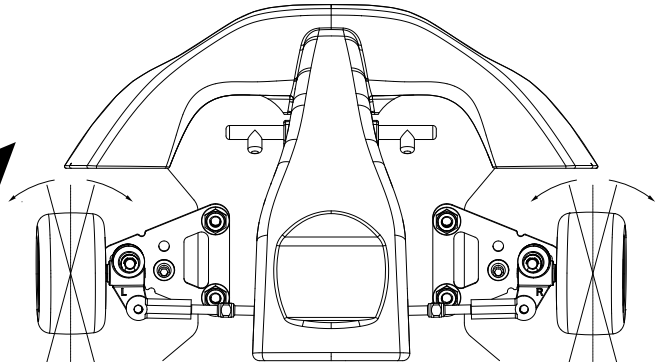

GROUND CLEARANCE

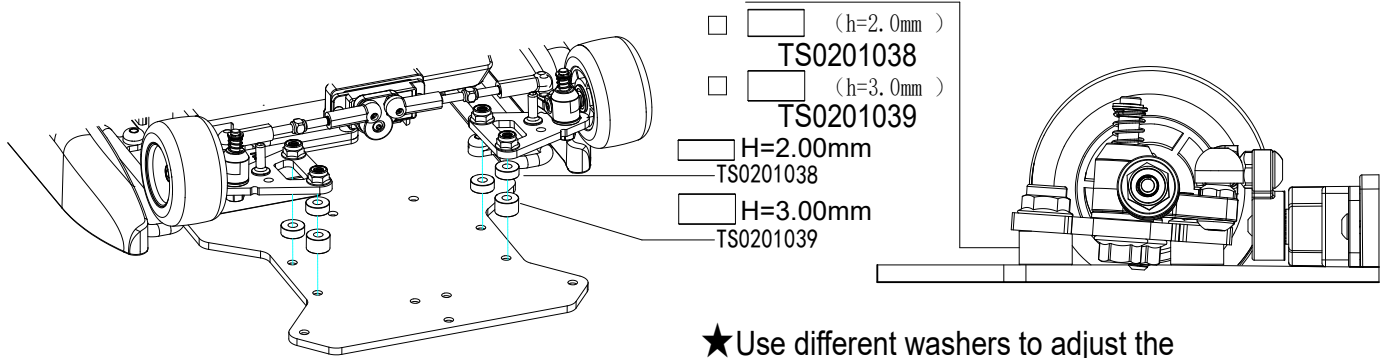

★ Use different washers to adjust the height and width of Front axle

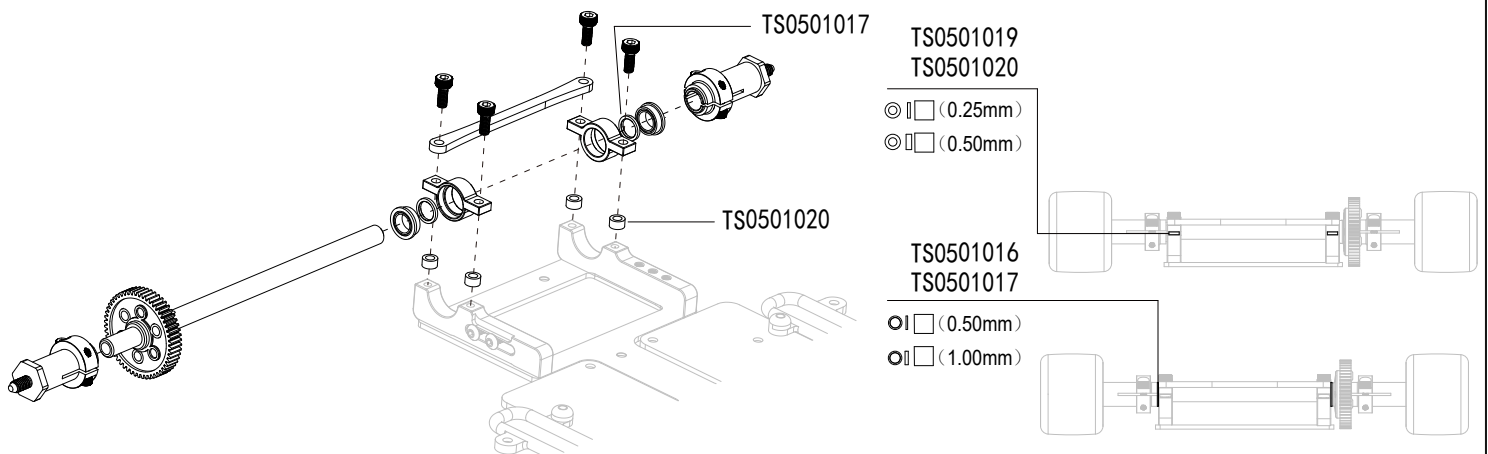

★ Use different washers to adjust the height and width of rear axle

VAPOR INDUSTRIAL CO., LTD

HTTP://WWW.SAXORACING.COM

E-MAIL:SAOXO@SAXORACING.COM



GIK-200

